



Property Report

Report Generated on 21 / 05 / 2026



 **38, Severn Road, Walsall, WS3 1NX**

3 Bed Semi-detached Property For Sale

Asking Price: £240,000

 01922322988

 elite@remax.co.uk



ABOUT US

At RE/MAX Elite, we are a proactive and professional estate agency specialising in residential sales, lettings, and commercial property across the West Midlands and surrounding areas.

REPORT CONTENT

ABOUT US	1
PROPERTY MAP OVERVIEW	3
PROPERTY SUMMARY	4
PROPERTY FABRICS	5
PROPERTY IMAGES	6
FLOOR PLAN	8
EPC	9
NEAREST PRIMARY SCHOOLS	10
NEAREST SECONDARY SCHOOLS	11
UNIVERSITIES AND COLLEGES	12
TRANSPORTATION LINKS	13
NEAREST HOSPITAL / GP / DENTIST / NHS	14
CONNECTIVITY	15



PROPERTY MAP OVERVIEW



PROPERTY SUMMARY

KEY FEATURES



£245,000

CURRENT MARKET
PRICE



Semi-Detached

PROPERTY TYPE



3

BEDROOMS



2

BATHROOMS



1,055.00 Sqft

(98.01 SQ. M.)
FLOOR AREA



£125,000

LAST SOLD PRICE



23-09-2016

LAST SOLD DATE



WM539498

TITLE NUMBER



Freehold

TENURE



1950-1966

YEAR BUILT



-

COMPANY OWNED



**Needs
Investigation**

FLOOD RISK



Not Available

SERVICE CHARGE



Not Available

GROUND RENT



A

TAX BAND



Not Available

TAX BAND PRICE



Not Available

LEASEHOLD TERM



Not Available

CHAIN STATUS

KEY DETAILS

Walsall

COUNCIL

West Midlands

COUNTY

Walsall and Bloxwich

CONSTITUENCY

West Midlands

REGION

65 / D

EPC RATING

[Domestic EPC in the Area](#)

[Non-Domestic EPC in the Area](#)

EPC RATINGS IN THE AREA

-

PLANNING APPLICATION

No

PARKING FACILITIES

No

ACCESSIBILITY FEATURES

Yes

GAS SUPPLY

Yes

ELECTRICITY SUPPLY

Yes

WATER SUPPLY

PROPERTY FABRICS

Know What It's Made Of Before You Invest

Property Geographic Information

UPRN :	100071082900
USRN :	41900795
UDPRN :	26884069
Street Description :	SEVERN ROAD
Parish Code :	-
Postcode :	WS3 1NX
Post town :	WALSALL
Thoroughfare :	SEVERN ROAD
Town :	BLOXWICH
Local custodian description :	WALSALL
Department Name :	-
Organisation name :	-
LA Organisation Name :	-
RM Organisation Name :	-
Legal Name :	-
Level :	-

Building Height & Area

Total Sqft Area :	1055 Sqft
Footprint Area :	547 Sqft
Plot Area :	795.77 m ²
Height :	164.1 m
AbsH2 :	162.6 m
AbsHMax :	164.1 m
AbsHMin :	157.8 m
RelH2 :	4.8 m
RelHMax :	6.3 m

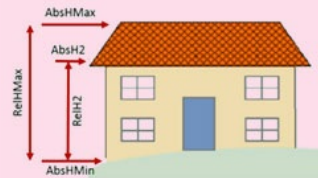

Building Information

Description :	Semi-Detached House
Building Use :	Residential Accommodation
Class :	RD03
Classification description main :	-
Classification description :	Semi-Detached
Multi Occupancy Count :	0
Connectivity :	Semi-Connected
Connectivity Count :	1
Building Part Count :	1
Containing site count :	1
Outbuilding count :	-
Construction Material :	Other Non-Standard Or System Build
Building age period :	1945-1959
Building age year :	-
Basement Presence :	Not Present
Address count :	1
Address count residential :	1
Address count commercial :	0

Building Energy Performance – Inspection Date 08-07-2016

Built form :	Semi-Detached	Unheated corridor :	-
Construction age band :	England and Wales: 1950-1966	Photo supply :	-
Building Ref Number :	0550975478	Solar water heating flag :	N
Floor height :	2.4 m	Fixed lighting outlets count :	-
Tenure :	Owner-occupied	Low energy fixed light count :	-
Floor level :	-	Energy traffic :	Single
Flat Top storey :	-	Main Gas flag :	Y
Flat storey count :	-	Main fuel :	Mains gas (not community)
Extension count :	1	Main Heating controls :	2104
Number habitable rooms :	5	Multi glaze proportion :	100
Number heated rooms :	5	Glazed type :	Double glazing installed during or after 2002
Low energy lighting :	92	Install date :	-
Number open fireplaces :	0	Glazed area :	More Than Typical
Wind turbine count :	0	Mechanical ventilation :	Natural
Heat loss corridor :	-	Unheated corridor length :	-

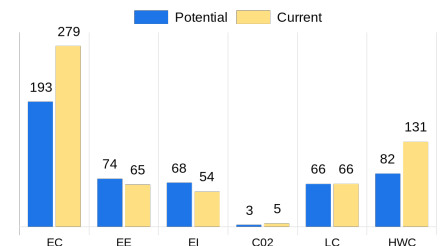

● Energy consumption current	279
● Energy consumption potential	193
● Energy efficiency current	65
● Energy efficiency potential	74
● Environment impact current	54
● Environment impact potential	68
● CO ₂ emissions current	5
● CO ₂ emissions potential	3
● Lighting cost current	66
● Lighting cost potential	66
● Hot water cost current	131
● Hot water cost potential	82

What is it?

Property Fabrics gives you a detailed breakdown of a building's physical structure, construction materials, energy efficiency, and essential location data. It includes key data points like property type, build age, roof/wall materials, EPC rating, glazing, heating type, and more — offering a full picture of what lies beneath the surface.

PROPERTY IMAGES

Browse through the property images to get a better idea -
Take a look at the property images.

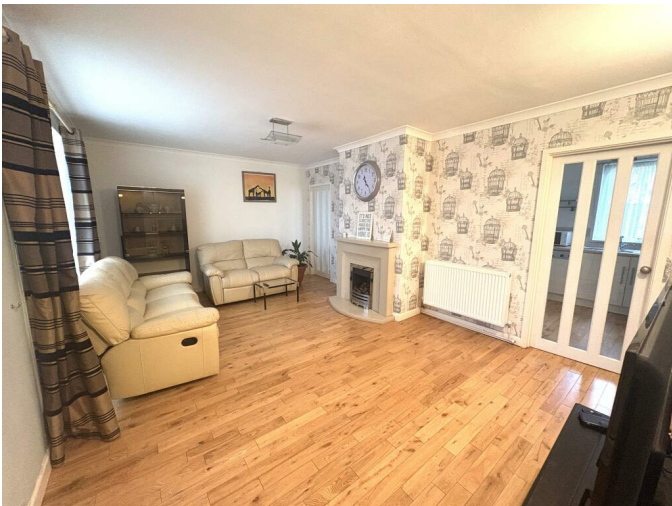

PROPERTY IMAGES



PROPERTY FLOOR PLAN

GROUND FLOOR



1ST FLOOR

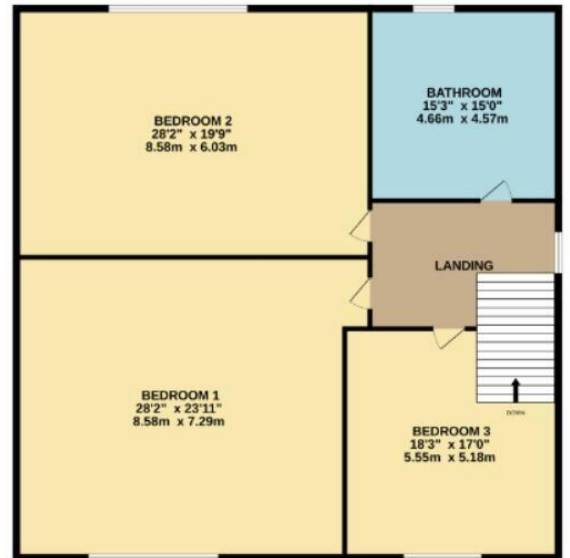

Whilst every attempt has been made to ensure the accuracy of the floorplan contained here, measurements of doors, windows, rooms and any other items are approximate and no responsibility is taken for any error, omission or mis-statement. This plan is for illustrative purposes only and should be used as such by any prospective purchaser. The services, systems and appliances shown have not been tested and no guarantee as to their operability or efficiency can be given.
 Made with Metropix ©2025

EPC - ENERGY PERFORMANCE CERTIFICATE

38, Severn Road,
Walsall,
WS3 1NX

Energy Rating

D

Valid until
08-07-2026

This property's current energy rating is **65/D**. It has the potential to be **74/C**.
See how to improve this property's energy efficiency.

Energy Efficiency Rating

Very Energy Efficient - Lower Running Costs	Current	Potential
(92+) A		
(81-91) B		
(69-80) C		74
(55-68) D	65	
(39-54) E		
(21-38) F		
(1-20) G		
Very Low Energy Efficient - Higher Running Costs		

Current Efficiency **65 / D**

Potential Efficiency **74 / C**

Inspection Date **08-07-2016**

Valid Until **08-07-2026**

Tenure **Owner-occupied**

Habitable Rooms **5**

Heated Rooms **5**

Local Authority **Walsall [E08000030 \(click to know more\)](#)**

Total Floor Area **1,055.00 Sq.Ft. (98.01 Sq.M.)**

Property Type **House**

Roof Efficiency **Very Good**

Wall Efficiency **Very Poor**

Window Efficiency **Good**

Floor Efficiency **Unknown**

Main Heating Efficiency **Good**

Secondary Heating Efficiency **-**

Hot Water Efficiency **Good**

Lighting Efficiency **Very Good**

Floors **-**

Floor Height **2.4(m)**

Roof	Pitched, 300 mm loft insulation
Walls	System built, as built, no insulation (assumed)
Window	Fully double glazed
Floor	Solid, no insulation (assumed)
Main Heating	Boiler and radiators, mains gas
Main Heating Controls	Programmer and room thermostat
Secondary Heating	Room heaters, mains gas
Hot Water System	From main system
Lighting	Low energy lighting in 92% of fixed outlets

NEAREST PRIMARY SCHOOLS

38, Severn Road, Walsall, WS3 1NX



Outstanding Good Requires Improvement Lowest Not Rated

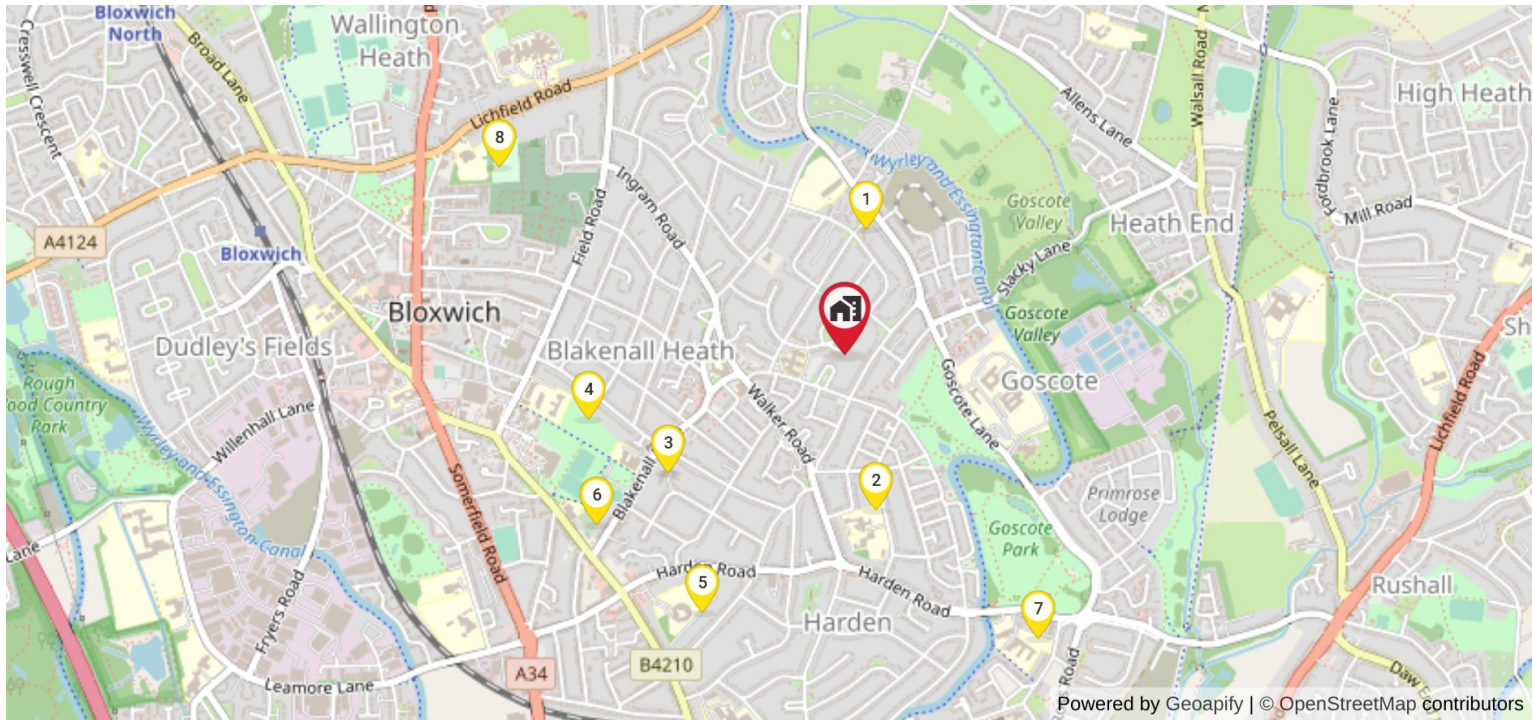

Powered by Geoapify | © OpenStreetMap contributors

1 Rivers Primary Academy
Livingstone Road, Blakenall, Walsall, West Midlands, WS3 1LY
419 **Mixed** **No** **No** **0.25 Miles**
PUPILS GENDER HAS NURSERY PRIVATE DISTANCE

2 Goldsmith Primary Academy
Goldsmith Road, Harden, West Midlands, WS3 1DL
441 **Mixed** **No** **No** **0.31 Miles**
PUPILS GENDER HAS NURSERY PRIVATE DISTANCE

3 Sunshine Infant and Nursery School
Blakenall Lane, Leamore, Walsall, West Midlands, WS3 1HF
197 **Mixed** **No** **No** **0.42 Miles**
PUPILS GENDER HAS NURSERY PRIVATE DISTANCE

4 Blakenall Heath Junior School
Field Road, Bloxwich, Walsall, West Midlands, WS3 3JF
227 **Mixed** **No** **No** **0.52 Miles**
PUPILS GENDER HAS NURSERY PRIVATE DISTANCE

5 Christ Church CofE Primary School
Harden Road, Leamore, WALSALL, West Midlands, WS3 1EN
406 **Mixed** **No** **No** **0.58 Miles**
PUPILS GENDER HAS NURSERY PRIVATE DISTANCE

6 Leamore Primary School
Bloxwich Road, Leamore, Walsall, West Midlands, WS3 2BB
233 **Mixed** **No** **No** **0.59 Miles**
PUPILS GENDER HAS NURSERY PRIVATE DISTANCE

7 Edgar Stammers Primary Academy
Harden Road, Coalpool, Walsall, West Midlands, WS3 1RQ
345 **Mixed** **No** **No** **0.68 Miles**
PUPILS GENDER HAS NURSERY PRIVATE DISTANCE

8 St Peter's Catholic Primary School, Bloxwich
Lichfield Road, Bloxwich, Walsall, West Midlands, WS3 3LY
221 **Mixed** **No** **No** **0.77 Miles**
PUPILS GENDER HAS NURSERY PRIVATE DISTANCE

NEAREST SECONDARY SCHOOLS

38, Severn Road, Walsall, WS3 1NX



Outstanding Good Requires Improvement Lowest Not Rated

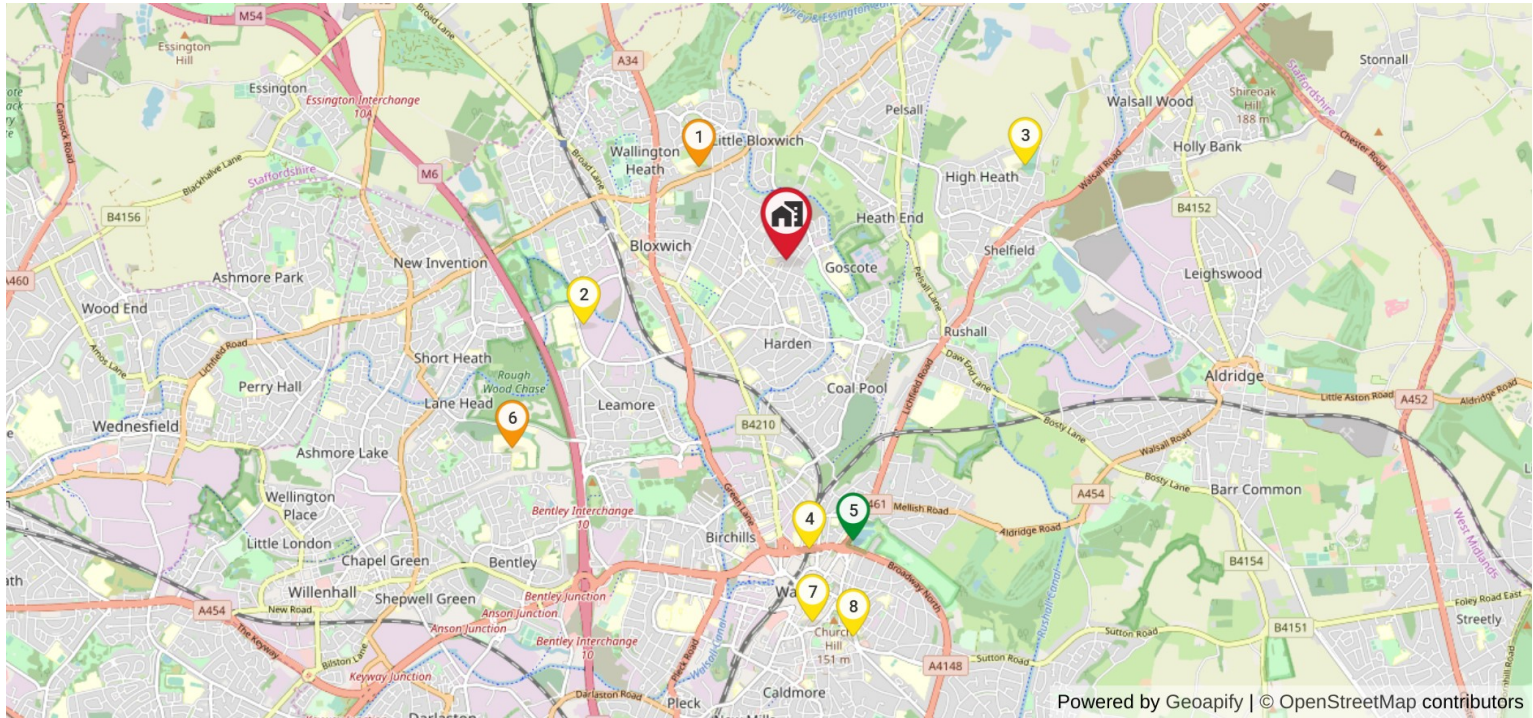

Powered by Geopify | © OpenStreetMap contributors

1 Walsall Academy
Lichfield Road, Bloxwich, Walsall, West Midlands, WS3 3LX

1365	Mixed	No	No	0.79 Miles
PUPILS	GENDER	HAS NURSERY	PRIVATE	DISTANCE

2 Bloxwich Academy
Leamore Lane, Bloxwich, Walsall, West Midlands, WS2 7NR

1491	Mixed	Yes	No	1.34 Miles
PUPILS	GENDER	HAS NURSERY	PRIVATE	DISTANCE

3 Ormiston Sheffield Community Academy
Broad Way, High Heath, Walsall, West Midlands, WS4 1BW

1409	Mixed	No	No	1.6 Miles
PUPILS	GENDER	HAS NURSERY	PRIVATE	DISTANCE

4 Walsall College
Wisemore Campus, Walsall, West Midlands, WS2 8ES

NA	Mixed	No	No	1.81 Miles
PUPILS	GENDER	HAS NURSERY	PRIVATE	DISTANCE

5 Queen Mary's High School
Upper Forster Street, Walsall, West Midlands, WS4 2AE

893	Girls	No	No	1.81 Miles
PUPILS	GENDER	HAS NURSERY	PRIVATE	DISTANCE

6 Willenhall E-ACT Academy
Furzebank Way, Willenhall, West Midlands, WV12 4BD

842	Mixed	No	No	2.09 Miles
PUPILS	GENDER	HAS NURSERY	PRIVATE	DISTANCE

7 Walsall Studio School
14a Lower Hall Lane, The Goldmine Centre, Walsall, West Midlands, WS1 1RL

260	Mixed	No	No	2.27 Miles
PUPILS	GENDER	HAS NURSERY	PRIVATE	DISTANCE

8 Blue Coat Church of England Academy
Birmingham Street, Walsall, West Midlands, WS1 2ND

879	Mixed	No	No	2.39 Miles
PUPILS	GENDER	HAS NURSERY	PRIVATE	DISTANCE

UNIVERSITIES & COLLEGES

 **38, Severn Road, Walsall, WS3 1NX**

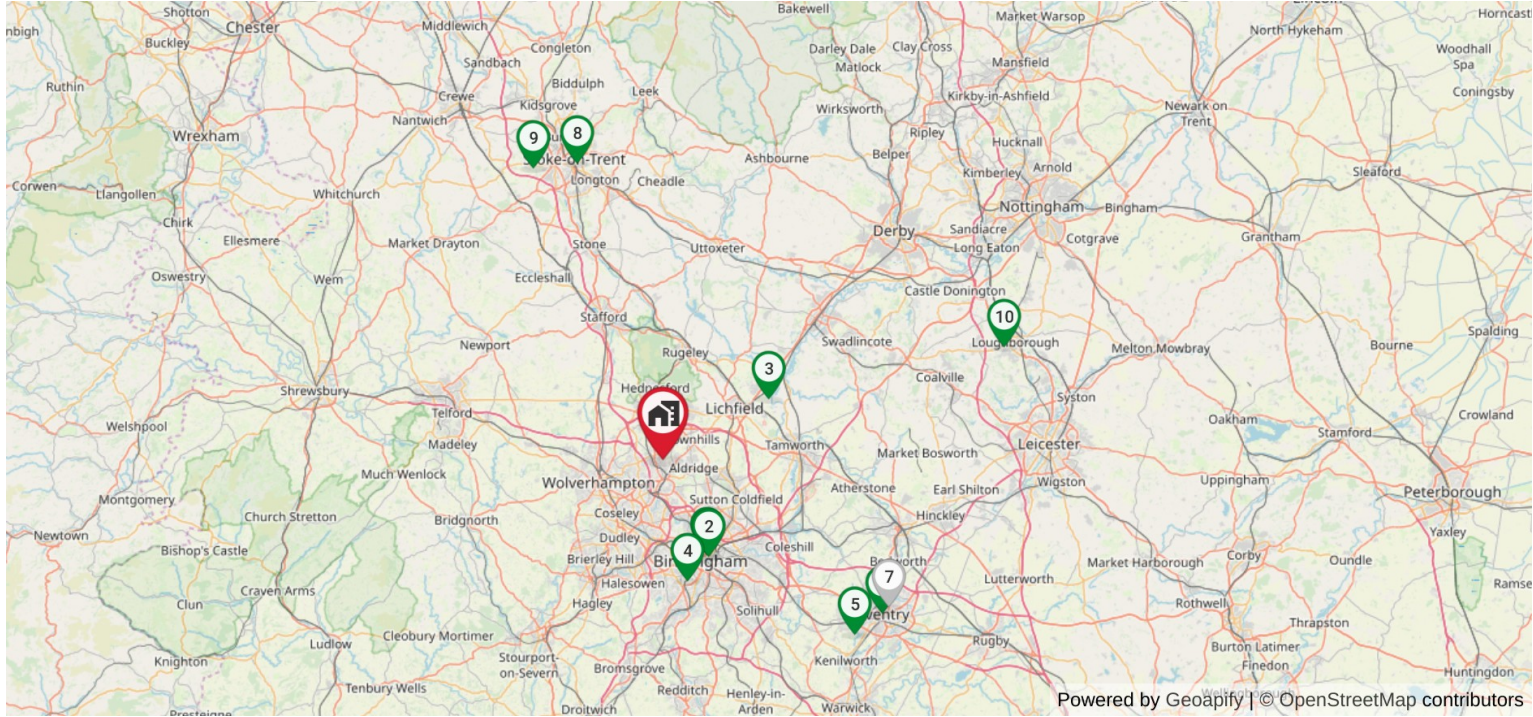

1 **Aston University** ★★★★★
Aston St, Birmingham B4 7ET, United Kingdom
9.73 Miles
DISTANCE

2 **Birmingham Conservatoire** ★★★★★
200 Jennens Rd, Birmingham B4 7XR, United Kingdom
9.94 Miles
DISTANCE

3 **Birmingham City University** ★★★★★
Birmingham City University
11.24 Miles
DISTANCE

4 **University of Birmingham** ★★★★★
Birmingham, United Kingdom
11.56 Miles
DISTANCE

5 **University of Warwick** ★★★★★
Coventry CV4 7AL, United Kingdom
24.11 Miles
DISTANCE

6 **Coventry University** ★★★★★
Priory St, Coventry CV1 5FB, United Kingdom
24.81 Miles
DISTANCE

7 **Ulster University**
Ulster university, Birmingham CV2 4GP, United Kingdom
24.98 Miles
DISTANCE

8 **Staffordshire University** ★★★★★
College Rd, Stoke-on-Trent ST4 2DE, United Kingdom
28.39 Miles
DISTANCE



9 **Keele University** ★★★★★
Keele, Newcastle ST5 5BG, United Kingdom
29.38 Miles
DISTANCE

10 **Loughborough University** ★★★★★
Epinal Way, Loughborough LE11 3TU, United Kingdom
33.16 Miles
DISTANCE

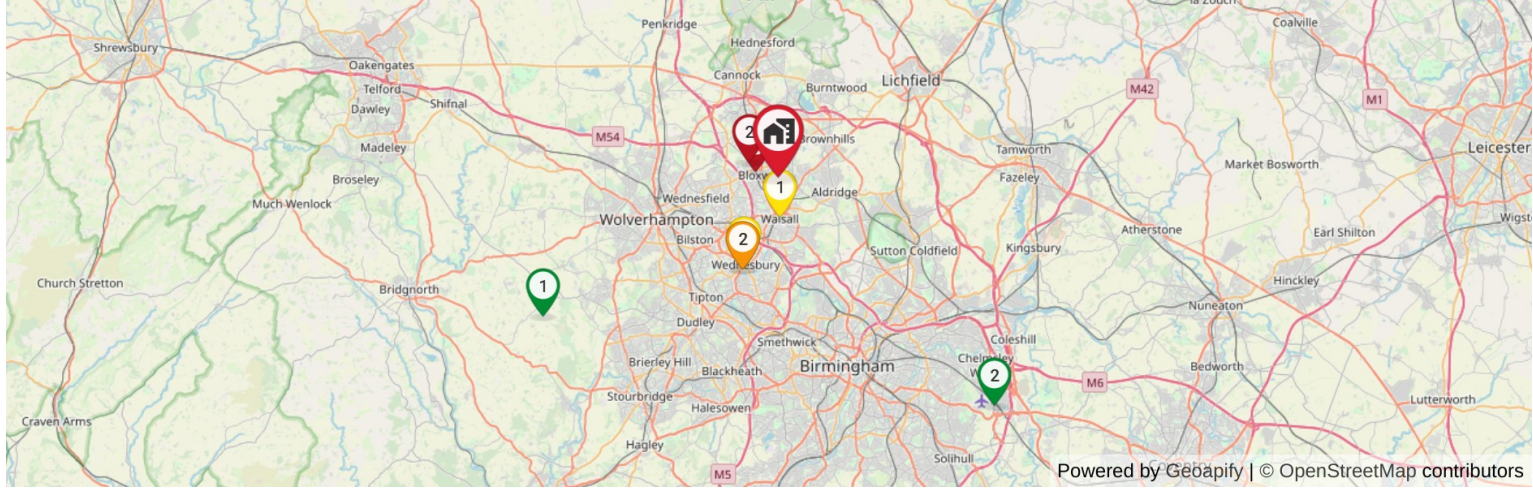

TRANSPORT LINKS





AIRPORTS

-  1 Wolverhampton Airport, Crab Ln, Stourbridge DY7 5DY, United Kingdom
13.58 Miles
-  2 Birmingham Airport, Trident Rd, Birmingham B26 3QJ, United Kingdom
15.63 Miles
-  3 Coventry Airport, Control Tower, Rowley Rd, Coventry CV3 4FR, United Kingdom
26.98 Miles

TRAIN STATION

-  1 Bloxwich, Bloxwich, Walsall WS3 2NR, United Kingdom
1.17 Miles
-  2 Bloxwich North, Bloxwich, Walsall WS3 2UB, United Kingdom
1.58 Miles
-  3 Walsall, Station St, Walsall WS2 9JS, United Kingdom
2.12 Miles

BUS STATION

-  1 St Paul's bus station, St. Pauls St, Walsall, UK
2.03 Miles
-  2 Wednesbury bus station, Wednesbury WS10 7DF
4.66 Miles
-  3 Wolverhampton bus station, Wolverhampton WV1 1LD
6.12 Miles

TRAM STATIONS

-  1 Wednesbury depot, Wednesbury WS10 7LL, United Kingdom
4.88 Miles
-  2 Wednesbury, Great Western Street, Wednesbury WS10 7LL, United Kingdom
4.88 Miles
-  3 Wednesbury Parkway, Wednesbury WS10 7DD, United Kingdom
4.93 Miles

NEAREST HOSPITALS / GP / DENTISTS / NHS

HOSPITALS (NHS)

Bloxwich Hospital
Reeves Street Walsall WS3 2JJ
0.87 Miles

Walsall Manor Hospital
Moat Road Walsall WS2 9PS
2.33 Miles

Manor Hospital
Moat Road Walsall WS2 9PS
2.33 Miles

GP (NHS)

RUSHALL MEDICAL CENTRE
107 Lichfield Road Rushall Walsall WS4 1HB
1.13 Miles

St John's Medical Centre
High Street Walsall Wood Walsall WS9 9LP
2.31 Miles

Drs K Conod & S Garsed
5 Birmingham Road Walsall Walsall WS1 2LX
2.4 Miles

DENTIST (NHS)

Allsopp Dental Practice
26 Bridge Street Walsall W Midlands WS1 1HR
2.09 Miles

mydentist, Bradford Street, Walsall
1-4 Arcade Balcony Walsall WS1 1PQ
2.15 Miles

Goodall Dental Practice
45 Goodall Street Walsall Walsall WS1 1QJ
2.2 Miles

HOSPITALS (CQC)

Homer Building
Charles Street Walsall WS2 9LZ
2.12 Miles

AIG Aesthetic Care
2 Goodall Street Walsall WS1 1QL
2.16 Miles

Manor Hospital
Moat Road Walsall WS2 9PS
2.33 Miles

GP (CQC)

Harden Blakenall Medical Centre
The Blakenall Village Centre 79 Thames Road Walsall WS3 1LZ
0.14 Miles

Dr's P L & S Kaul and Dr G K Gill
Harden Road Bloxwich Walsall WS3 1ET
0.44 Miles

Pinfold Medical
Field Road Bloxwich Walsall WS3 3JP
0.7 Miles

DENTIST (CQC)

Harden Dental Surgery
168 Walker Road Walsall WS3 1BZ
0.34 Miles

Priory Dental Practice (Leamore) Limited
652 Bloxwich Road Walsall WS3 2BA
0.62 Miles

First Dental
124 High Street Bloxwich Walsall WS3 2DG
0.79 Miles

RESPONSE TIMES OF NHS SERVICES

Category	Approx. Response Time	
C1	00 hrs 08 mins 13 secs	C1: Calls from people with life-threatening illnesses or injuries such as cardiac arrest or serious allergic reaction (fastest response)
C1T	00 hrs 08 mins 45 secs	C1T: Calls from people with life-threatening illnesses or injuries such as cardiac arrest or serious allergic reaction where the patient was transported (fastest response)
C2	00 hrs 39 mins 32 secs	C2: Emergency calls for conditions and injuries such as burns, epilepsy and strokes (high priority)
C3	03 hrs 14 mins 47 secs	C3: Urgent calls for conditions and injuries such as late stages of labour, non-severe burns, and diabetes. Transportation to A&E may not be required
C4	03 hrs 39 mins 35 secs	C4: Less urgent calls for conditions such as diarrhoea and vomiting and urine infections and flu. Advice via phone / GP referral may be recommended over the phone

BROADBAND & MOBILE

Broadband - Predicted Broadband Speeds



Speed Type	Download Speed	Upload Speed
Basic	30 Mbps	2 Mbps
Superfast	76 Mbps	20 Mbps
Ultrafast	1800 Mbps	220 Mbps

Mobile Coverage - Based on voice calls made



EE	Vodafone	3	O2
INDOOR SPEED No Signal	INDOOR SPEED Good	INDOOR SPEED Very Good	INDOOR SPEED Very Good
OUTDOOR SPEED Low	OUTDOOR SPEED Good	OUTDOOR SPEED Very Good	OUTDOOR SPEED Very Good



 549 Bloxwich Road
Walsall
WS3 2XD

 **Tel: 01922322988**

 Email: elite@remax.co.uk

DATA PROVIDERS

HM Land Registry 

 Department for Transport

 Office for National Statistics



 Ordnance Survey

Google



 Geoapify



NHS

 Care Quality Commission

Disclaimer : The information contained within this report is for general information purposes only and to act as a guide.

Lets Bid Property aggregate this data from a wide variety of sources and while we endeavour to keep the information up to date and correct, we make no representations or warranties of any kind, express or implied, about the completeness, accuracy, reliability, of the information or related graphics contained within this report for any purpose. Any reliance you place on such information is therefore strictly at your own risk. In no event will we be liable for any loss or damage including without limitation, indirect or consequential loss or damage, or any loss or damage whatsoever arising from loss of data or profits arising out of, or in connection with, the use of this report.